

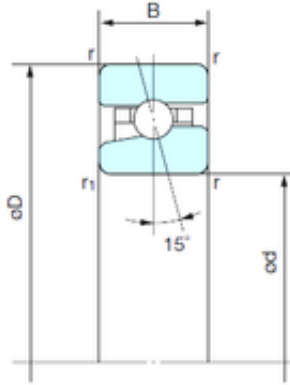

# KRS Guide Wheel Bearing Co., Ltd

85 mm x 130 mm x 22 mm NACHI BNH 017  
angular contact ball bearings



Bearing No. BNH 017

Size	85x130x22 mm
Bore Diameter	85 mm
Outer Diameter	130 mm
Width	22 mm
d	85 mm
D	130 mm
B	22 mm
C	22 mm
Angle ( ° )	15 °
r min.	1.1 mm
r1 min.	0.6 mm
Basic dynamic load rating (C)	35,5 kN
Basic static load rating (C0)	40 kN
(Grease) Lubrication Speed	11000 r/min

BNH 017 Bearing 2D drawings and 3D CAD models