

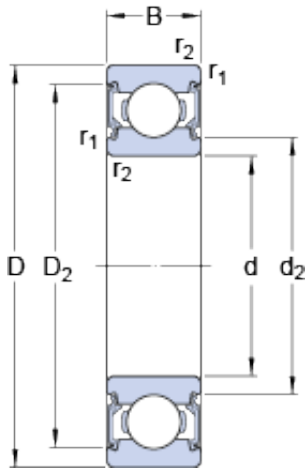

KRS Guide Wheel Bearing Co., Ltd



20 mm x 47 mm x 14 mm SKF 6204-2RSL deep groove ball bearings

Bearing No. 6204-2RSL

6204-2RSL Bearing 2D drawings and 3D CAD models

| | |
|---|--------------------------|
| Size | 47x20x14 mm |
| Bore Diameter | 47 mm |
| Outer Diameter | 20 mm |
| Width | 14 mm |
| d | 20 mm |
| D | 47 mm |
| B | 14 mm |
| d ₂ | 26.05 mm |
| D ₂ | 40.59 mm |
| r _{1,2} - min. | 1 mm |
| d _a - min. | 25.6 mm |
| d _a - max. | 26 mm |
| D _a - max. | 41.4 mm |
| r _a - max. | 1 mm |
| Basic dynamic load rating - C | 13.5 kN |
| Basic static load rating - C ₀ | 6.6 kN |
| Fatigue load limit - P _u | 0.28 kN |
| Reference speed | 32000 r/min |
| Limiting speed | 17000 r/min |
| Calculation factor - k _r | 0.025 |
| Calculation factor - f ₀ | 13 |
| Category | Single Row Ball Bearings |
| Inventory | 0.0 |
| Manufacturer Name | SKF |



KRS Guide Wheel Bearing Co., Ltd

| | |
|---------------------------------|---|
| Minimum Buy Quantity | N/A |
| Weight / Kilogram | 0.114 |
| EAN | 7316571823928 |
| Product Group | B00308 |
| Enclosure | 2 Seals |
| Precision Class | ABEC 1 ISO P0 |
| Maximum Capacity / Filling Slot | No |
| Rolling Element | Ball Bearing |
| Snap Ring | No |
| Internal Special Features | No |
| Cage Material | Steel |
| Enclosure Type | Contact Seal |
| Internal Clearance | C0-Medium |
| Inch - Metric | Metric |
| Long Description | 20MM Bore; 47MM Outside Diameter; 14MM Outer Race Width; 2 Seals; Ball Bearing; ABEC 1 ISO P0; No Filling Slot; No Snap Ring; No Internal Special Features; C0-Medium Internal Clearance; Steel Cage; |
| Other Features | Deep Groove Low Friction NBR Seal |
| Category | Single Row Ball Bearing |
| UNSPSC | 31171504 |
| Harmonized Tariff Code | 8482.10.50.68 |
| Noun | Bearing |
| Keyword String | Ball |
| Manufacturer URL | http://www.skf.com |
| Manufacturer Item Number | 6204-2RSL |
| Weight / LBS | 0.234 |
| Outside Diameter | 1.85 Inch 47 Millimeter |
| | |



KRS Guide Wheel Bearing Co., Ltd

| | |
|--------------------------------|----------------------------|
| Outer Race Width | 0.551 Inch 14 Millimeter |
| Inner Race Width | 0 Inch 0 Millimeter |
| Bore | 0.787 Inch 20 Millimeter |
| bore diameter: | 20 mm |
| static load capacity: | 6.55 kN |
| outside diameter: | 47 mm |
| finish/coating: | Uncoated |
| overall width: | 14 mm |
| bearing material: | Steel |
| bore type: | Round |
| cage material: | Steel |
| closure type: | Double Sealed |
| fillet radius: | 1 mm |
| row type & fill slot: | Single Row Non-Fill Slot |
| maximum rpm: | 32000 rpm |
| snap ring included: | Without Snap Ring |
| weight: | 0.23 lb |
| operating temperature range: | -40 to 212 ° F ° F |
| manufacturer product page: | Click here |
| dynamic load capacity: | 13.5 kN |
| manufacturer upc number: | 7316571823928 |
| d_2 | 25.46 mm |
| D_2 | 40.59 mm |
| $r_{1,2}$ min. | 1 mm |
| d_a min. | 25.6 mm |
| d_a max. | 26 mm |
| D_a max. | 41.4 mm |
| r_a max. | 1 mm |
| Basic dynamic load rating C | 13.5 kN |
| Basic static load rating C_0 | 6.55 kN |
| Fatigue load limit P_u | 0.28 kN |
| Calculation factor k_r | 0.025 |



KRS Guide Wheel Bearing Co., Ltd

| | |
|--------------------------|---------|
| Calculation factor f_0 | 13 |
| Mass bearing | 0.11 kg |