

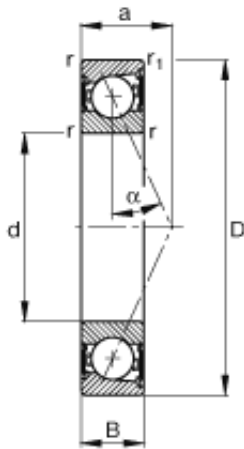

# KRS Guide Wheel Bearing Co., Ltd



## 25 mm x 52 mm x 15 mm FAG B7205-E-2RSD-T-P4S angular contact ball bearings

Bearing No. B7205-E-2RSD-T-P4S

B7205-E-2RSD-T-P4S Bearing 2D drawings and 3D CAD models

Size	25x52x15 mm
Bore Diameter	25 mm
Outer Diameter	52 mm
Width	15 mm
d	25 mm
D	52 mm
B	15 mm
a	17 mm
$D_a$	45,5 mm / Tolerance: H12
$d_a$	31,5 mm / Tolerance: h12
$r_{1 \text{ min}}$	1 mm
$r_{a \text{ max}}$	1 mm
$r_{a1 \text{ max}}$	1 mm
$r_{\text{min}}$	1 mm
	25 ° / Angle
m	0,13 kg / Weight
$C_r$	17500 N / Dynamic load rating (radial)
$C_{0r}$	8800 N / Static load rating (radial)
$n_{G \text{ Fett}}$	26000 1/min / Limiting speed for grease lubrication