

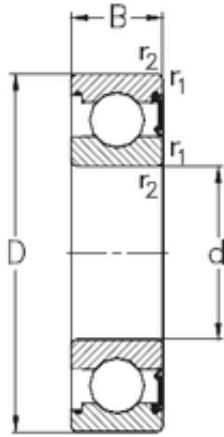

KRS Guide Wheel Bearing Co., Ltd



110 mm x 170 mm x 28 mm NKE 6022-RSR
deep groove ball bearings

Bearing No. 6022-RSR

| | |
|-------------------------------|---------------|
| Size | 110x170x28 mm |
| Bore Diameter | 110 mm |
| Outer Diameter | 170 mm |
| Width | 28 mm |
| d | 110 mm |
| D | 170 mm |
| B | 28 mm |
| C | 28 mm |
| r1 min. | 2 mm |
| r2 min. | 2 mm |
| Weight | 1,97 Kg |
| Basic dynamic load rating (C) | 82 kN |
| Basic static load rating (C0) | 73 kN |

6022-RSR Bearing 2D drawings and 3D CAD models